

FOURTH ANNUAL NORTHERN CALIFORNIA SEMINAR



California Society for Healthcare Engineering, Inc.

“Going Green: Concept Versus Reality”

Thursday, October 28, 2010
8:00 a.m. – 3:30 p.m.

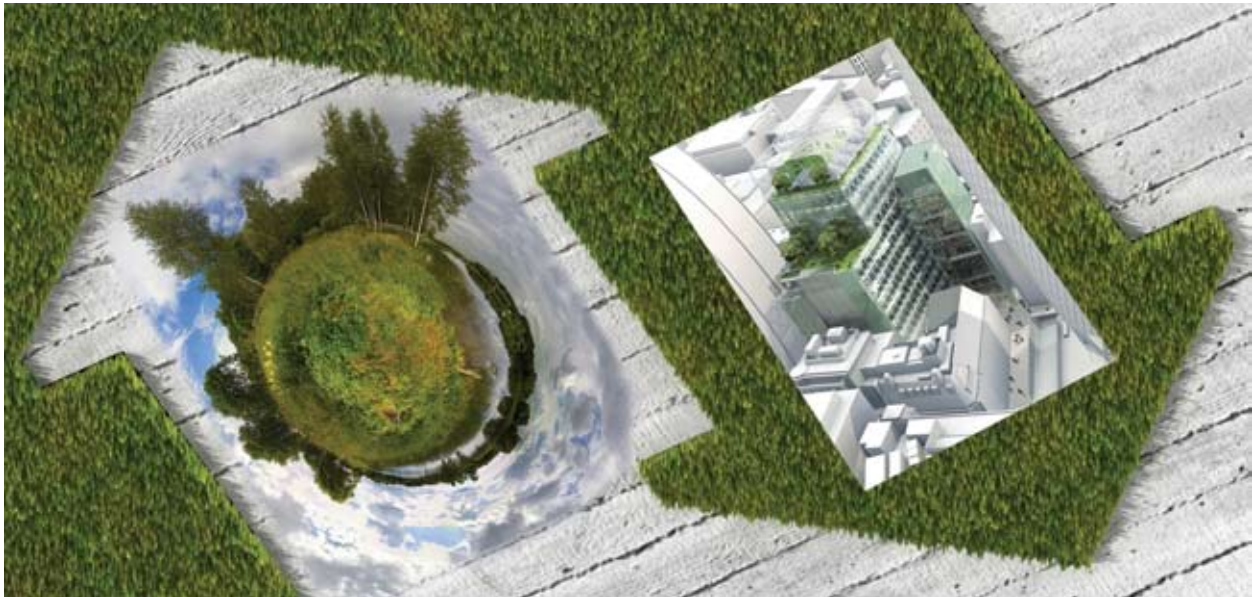

Crowne Plaza Hotel – Concord

45 John Glen Drive, Concord, CA 94520

Toll Free: 877-276-4600 • Fax: 925-689-5326 • www.crowneplaza.com

Stay after the Seminar for Golf at the Buchanan Field 9-Hole Executive Golf Course

Management Track

Technical Track One

Technical Track Two

8:00 – 8:55 *Registration and Exhibits*

Registration and Exhibits

Registration and Exhibits

9:00 – 10:00 **Hydrogen Fuel Cell Cogeneration Technology, Is it the Right Fit for hospitals?**

Stan Tempchin, Executive Director
St. Helena Hospital
Vito J. Coletto, General Manager-CA
UTC Power Corporation

St. Helena Hospital has installed a 400KW Fuel Cell to supplement the hospitals electric and heat consumption from the utilities. Topics for this presentation: The permit process, options for tie of electric production to hospital grid, methodology for utilization of waste heat production, financial proforma, and California Self Generating Incentive Program (SGIP) funding.

Increased Sustainability with Proper Cooling Tower Disinfection & Cleaning

Britt Rodgers, President
Precept Environmental, Inc.

Proper Cooling Tower Disinfection and Cleaning protocols can provide higher efficiencies, lower water consumption, lower chemical requirements, and reduce the potential for *Legionella* bacteria to proliferate in the condenser water systems. This presentation will describe these protocols in detail to help create greater environmental sustainability in your cooling tower for operational improvements and safety.

Seismic Issues and Tier Four Emissions Requirements for Diesel Generators in California

Rich Lund, Sales Manager
Holt of California

New seismic and emissions requirements for diesel generators in California will require additional planning for healthcare engineers. This presentation will cover the impacts of these issues and provide guidance to help understand the cost, design, and extended lead time implications.

10:00– 11:00 **Seismic, Noise Remediation, and SB 499 Round Table Discussion**

Tony Moddesette, VP Facilities and Projects
Fremont Rideout Health Group

As a member of the Hospital Building Safety Board (HBSB), Mr. Moddesette will provide an update on issues the HBSB is addressing, through its ad hoc committees, which are of interest to hospitals.

Benefits of Combined Heat and Power Systems

Andy Freeman, National Sales Manager
Ingersoll Rand Energy Systems

Discuss the benefits from state and federal rebate money for installing a combined heat and power system that will provide low cost, low maintenance and clean onsite power. Other topics: a technology overview, lifetime cost/benefit projected energy savings, permit compliance, rebate availability and typical project timelines.

How to Meet Fire Safety Codes EOC

Lazaro Rojas, Chief Engineer
Novato Community Hospital

Preparation for a Life Safety survey for an organization must be continuously complying with codes, regulations and standards. The presenter will share his survey tools and techniques that produced 'no' Life Safety findings in his 2010 TJC survey.

11:00 – 12:30 *Exhibit Show*

Exhibit Show

Exhibit Show

12:45 – 1:30 *Lunch in the Atrium*

Lunch in the Atrium

Lunch in the Atrium

1:30 – 2:25 **Can Medical Records Really Be Paperless?**

Pamela Lane, VP Health Informatics
California Hospital Association

HIT has the potential to reform health care in your facility. This up close and personal look at HIT will help you ask informed questions and understand how electronic health records will impact your world.

Description of (Predictive Maintenance) PdM as it Applies to Healthcare

Shannon Harwell, President/Operations Manager
Redline PdM
Dave Lockhart BVE, CHFM, Project Manager
Kaiser Medical Center

Discuss the technologies and equipment used in predictive maintenance, i.e. vibrations analysis, thermo scan, and oil analysis and what these technologies can do for us in predicting our failures and maintenance needs. What it takes to plan and implement such a system in a facility and share the pros and cons with the positive and negative outcomes.

Cooling and Heating Load Estimation

Pete Hugenroth, Healthcare Segment Leader
Trane/Ingersoll Rand

Have you ever wondered if that office or patient room with the temperature "problem" is getting enough cooling or heating? Have you wanted to relocate a duct during a remodel but did not because you were not sure how much air was enough (or too much!). In this interactive session, learn how to do heating and cooling load calculations on a room, a wing or a building.

2:30 – 3:30 **Building Green for Less Green**

Paul Pratt, Project Manager and Sustainability Advisor, Lionakis

What factors affect the cost of building green? This presentation will discuss the variables involved that affect the cost and potential success of green projects. We will review some of the paybacks and benefits that offset costs and go over tips that can be applied to potential projects.

Systems Approach to Plant Efficiency and Maintaining Control

Bob Thiele P.E., Principal
R & A Engineering Solutions, Inc.
Harold Hougham, Principal
R & A Engineering Solutions, Inc.

Optimizing the operation of a chilled water plant is more than just chiller efficiency. Learn how chillers, pumps, controls and building loads work together as a system to reduce, or increase, your plant's energy bill.

Want to Learn More About BAAQMD Regulation 9, Rule 7?

Donald Patten, Co-Service Manager
R. F. MacDonald Co.

Bay Area Air Quality Management District has a rule change for Boiler emissions that requires compliance beginning January 1, 2011.

3:45 – 5:45 **Golf at the Buchanan Field 9-Hole Executive Golf Course**

Registration Form — 4th Annual Northern California Seminar

Registration

Registration Fees	Before 10/1	After 10/1
CSHE Member	\$ 95	\$120
Non-Member*	\$145	\$170

*Facility registrants will receive one-year membership in CSHE.

(Fee includes: continental breakfast,
educational materials and lunch)

Luncheon Ticket Guest Only		\$ 35
Membership Dues	Facility	\$ 50
Membership Dues	Affiliate	\$150
MECH Study Manual	Member	\$ 51
MECH Study Manual	Non-Member	\$ 58
MECH Certification Test	Member	\$ 95
MECH Certification	Non-Member	\$140
Golf		\$25

Enclosed Fees:

Seminar Registration	\$ _____
Luncheon (guest only)	\$ _____
Membership Dues	\$ _____
MECH Study Manual	\$ _____
MECH Test	\$ _____
Golf	\$ _____
TOTAL ENCLOSED	\$ _____

Mechanic Evaluation Certification for Healthcare (MECH) Certification Exam

An individual currently employed as a health care mechanic with the appropriate years of documented experience may have the skills and ability to become certified. It is mandatory that years of experience be an integral part of certification: two years for a certified mechanic and four years for the senior certified mechanic are required. Contact the CSHE office to request a MECH brochure and for additional information.



Method of Payment

Do you require a receipt? Yes No
 Check enclosed Check # _____
 Visa MasterCard No American Express

16-Digit Account Number

Three digit security code on the back of card

Expiration Date

ZIP

Signature

Make checks payable to CSHE.

Please return this form with fees to:

CSHE
1215 K Street, Suite 800
Sacramento, CA 95814
Phone: (916) 552-7639
Fax: (916) 552-7617
Email: jjones@calhospital.org

**To register online, go to www.cshe.org,
then click on "Northern CA Seminar"**

Exhibitor Packets are available by calling (916) 552-7639 or on CSHE's website at www.cshe.org.

Please print clearly — One person per form (photocopies acceptable)

Last Name

First Name

Title

E-mail Address

Hospital/Organization

Address

City

State

Zip

Phone

Fax

Cell Phone

Please check for vegetarian meal option.

Attendee Information

Hotel Accommodations

Crowne Plaza Hotel – Concord

45 John Glenn Drive

Concord, CA 94520

Toll Free: (877) 276-4600

Main Number: (925) 825-7700 • Fax: (925) 689-5326

www.crowneplaza.com

Single/Double: \$99

Make your reservations directly with the hotel by calling (877) 276-4600. Please identify CSHE to receive the Group Block rate.

The hotel has blocked rooms at the group rate until October 14.

Reservations received after that date will be subject to general availability and the hotels' current rate.



Parking and Transportation

Complimentary parking. Complimentary shuttle service is provided within a five-mile radius of the hotel, including the Concord BART (Bay Area Rapid Transit) station. Go to www.bart.gov, for more information.

For directions go to Map Quest at www.mapquest.com.

Cancellation Policy

Cancellation must be in writing and faxed to (916) 552-7617 prior to October 15, 2010. A \$35 non-refundable processing fee will be charged. After October 15, cancellations and non-attending registrants are responsible for the full registration fee.

Substitutions are encouraged.

Americans with Disabilities Act

If you require special accommodations pursuant to the Americans with Disabilities Act, please call (916) 558-7639.

CHFM and MECH

Continuing Education Units

At the end of the seminar, Certificates of Attendance will be available for **four** continuing education units.



California Society for Healthcare Engineering, Inc.

1215 K Street, Suite 800

Sacramento, CA 95814

Phone: (916) 552-7639

www.cshe.org

First Class
U.S. Postage
PAID
Permit No. 1409
Sacramento, CA